



COUNTY OF MENDOCINO
DEPARTMENT OF PLANNING AND BUILDING SERVICES
 501 LOW GAP ROAD · ROOM 1440 · UKIAH · CALIFORNIA · 95482

IGNACIO GONZALEZ, DIRECTOR
 Telephone 707-463-4281
 FAX 707-463-5709
 pbs@co.mendocino.ca.us
 www.co.mendocino.ca.us/planning

July 11, 2011

Planning – Fort Bragg
 Department of Transportation
 Environmental Health - Fort Bragg
 Building Inspection - Fort Bragg
 Assessor
 Farm Advisor
 Agriculture Commissioner

Forestry Advisor
 Air Quality Management
 County Water Agency
 Resource Lands Program Committee
 Native Plant Society
 Caltrans
 Department of Forestry/ CalFire

Department of Fish and Game
 Coastal Commission
 RWQCB
 Department of Conservation
 Westport MAC

CASE#: CDUR 7-94/2011

DATE FILED: 5/31/2011

OWNER: JACKSON GRUBE FAMILY INC

APPLICANT: RONELLE McMAHON

REQUEST: Coastal Development Use Permit and Reclamation Plan Renewal to extend an existing hillside quarry mining operation for an additional 5 years. Extraction of up to 42,000 cubic yards (cy) of material (average 8,400 cy/yr) with up to 15,000 cubic yards in any one year.

LOCATION: Within the Coastal Zone, approximately 2.5 miles south of Westport, lying 0.5+/- miles east of Highway One, 1+/- miles south of its intersection with Bruhel Point Road (private), located at 33051 North Highway One; AP# 015-070-40.

PROJECT COORDINATOR: JOHN SPEKA

RESPONSE DUE DATE: 7/26/2011

Attached to this form is information describing the above noted project(s). The County Planning and Building Services Department is soliciting your input, which will be used in staff analysis, and will be forwarded to the appropriate public hearing.

You are invited to comment on any aspect of the proposed project(s). Please address any concerns or recommendations on environmental considerations and specific information regarding permits you may require to the project coordinator at the above address or submit your comments by email to pbs@co.mendocino.ca.us. Please note the case number and name of the project coordinator with all correspondence to this department.

We have reviewed the above application and recommend the following (please check one):

- Recommend approval. The Department has no comment at this time.
- Recommend conditional approval (Suggested condition(s) attached).
- Applicant to submit additional information (Attach list of items needed).
- Recommend denial (Attach reasons for recommend denial).
- Recommend preparation of an Environmental Impact Report (Attach reasons why an EIR should be required).
- Other comments (Attach additional sheets if necessary).

REVIEWED BY:

Signature _____ Department _____ Date _____

REPORT FOR: Coastal Development Use Permit and Reclamation Plan Renewal CASE #: CDUR 7-94/11

OWNER: Jackson Grube Family, Inc.

APPLICANT: Ronelle McMahon

REQUEST: Coastal Development Use Permit and Reclamation Plan Renewal to extend existing hillside quarry mining operation for an additional 5 years. Extraction of up to 42,000 cubic yards (cy) of material (avg 8,400 cy/yr) with up to 15,000 cy in any one year.

LOCATION: Within the Coastal Zone, approximately 2.5 mi S of Westport, lying 0.5± mi E of Hwy One, 1± mi S of its intersection with Bruhel Point Rd (Pvt Rd).

STREET ADDRESS: 33051 North Highway 1, Fort Bragg **ACREAGE:** 96 acres

GENERAL PLAN: FL160 and RL160 **ZONING:** FL 160 and RL 160 **COASTAL ZONE:** Yes

EXISTING USES: Rock Quarry, Residential **SUPERVISORIAL DISTRICT:** 4

TOWNSHIP: 20N **RANGE:** 17W **SECTION:** 17 **USGS QUAD#:** 27-A

RELATED CASES: U 40-76, UR 40-76/78, U 98-83, CDU 7-94, CC 36-95, A 2-05, CDUR 7-94/06

	ADJACENT GENERAL PLAN	ADJACENT ZONING	ADJACENT LOT SIZES	ADJACENT USES
NORTH:	FL160	TP 160	40 ac	Timberland
EAST:	FL160	TP 160	714.5± ac	Timberland
SOUTH:	FL160 and RL160	FL 160 and RL 160	148.8± ac	Timberland
WEST:	RL160 and RMR40	RL 160 and UR 40	126.4± ac	Timberland

REFERRAL AGENCIES:

- | | | |
|--|--|---|
| <input checked="" type="checkbox"/> Planning (FB) | <input checked="" type="checkbox"/> Resource Lands Committee | <input type="checkbox"/> US Fish & Wildlife Service |
| <input checked="" type="checkbox"/> Department of Transportation | <input type="checkbox"/> Trails Advisory Council | <input type="checkbox"/> Army Corps of Engineers |
| <input checked="" type="checkbox"/> Environmental Health (Ukiah - FB) | <input checked="" type="checkbox"/> Native Plant Society | <input type="checkbox"/> Soil Conservation Service |
| <input checked="" type="checkbox"/> Building Inspection (Ukiah - FB) | <input type="checkbox"/> ALUC | <input type="checkbox"/> LAFCO |
| <input type="checkbox"/> Emergency Services | <input checked="" type="checkbox"/> Caltrans | <input type="checkbox"/> MTA |
| <input checked="" type="checkbox"/> Assessor | <input checked="" type="checkbox"/> Department of Forestry | <input checked="" type="checkbox"/> Westport MAC |
| <input checked="" type="checkbox"/> Farm Advisor | <input checked="" type="checkbox"/> Department of Fish & Game | <input type="checkbox"/> CHP |
| <input checked="" type="checkbox"/> Agriculture Commissioner | <input type="checkbox"/> | <input type="checkbox"/> Addresser |
| <input checked="" type="checkbox"/> Forestry Advisor | <input checked="" type="checkbox"/> Coastal Commission | <input type="checkbox"/> NRCS |
| <input checked="" type="checkbox"/> Air Quality Management District | <input checked="" type="checkbox"/> RWQCB | <input type="checkbox"/> State Int Waste Mgmt |
| <input type="checkbox"/> Fish & Game Advisory | <input type="checkbox"/> Department of Health Services | <input type="checkbox"/> NOAA Fisheries |
| <input checked="" type="checkbox"/> County Water Agency | <input checked="" type="checkbox"/> Department of Conservation | <input type="checkbox"/> PG and E |
| <input type="checkbox"/> Archaeological Commission | <input type="checkbox"/> Department of Parks & Recreation | <input type="checkbox"/> Community Services |
| <input type="checkbox"/> Sonoma State University | <input type="checkbox"/> State Clearinghouse | <input type="checkbox"/> School District |
| <input type="checkbox"/> Russian River Flood Control/Water Conservation Improvement District | | <input type="checkbox"/> County Solid Waste Mgmt |

ADDITIONAL INFORMATION:

ASSESSOR'S PARCEL #: 015-070-40

PROJECT COORDINATOR: John Speka **PREPARED BY:** JS **DATE:** 6/28/2011

**ENVIRONMENTAL DATA
(To be completed by Planner)**

		COUNTY WIDE
Yes	No	
<input type="checkbox"/>	<input checked="" type="checkbox"/>	1. Alquist-Priolo Earthquake Fault Zone.
<input type="checkbox"/>	<input checked="" type="checkbox"/>	2. Hazard/Landslides Map.
<input type="checkbox"/>	<input checked="" type="checkbox"/>	3. Floodplain/Floodway Map.
<input checked="" type="checkbox"/>	<input type="checkbox"/>	4. Within/Adjacent to Agriculture Preserve or Timberland Production.
<input checked="" type="checkbox"/>	<input type="checkbox"/>	5. Fire Hazard Severity Classification: <input type="checkbox"/> LRA <input checked="" type="checkbox"/> SRA-CDF# Moderate Fire Hazard Area
<input type="checkbox"/>	<input checked="" type="checkbox"/>	6. Wild and Scenic River.
<input type="checkbox"/>	<input checked="" type="checkbox"/>	7. Adjacent to State Forest/Park/Recreation Area.
<input type="checkbox"/>	<input checked="" type="checkbox"/>	8. Adjacent to Equestrian/Hiking Trail.
<input type="checkbox"/>	<input checked="" type="checkbox"/>	9. Within/Near Hazardous Waste Site.
<input type="checkbox"/>	<input checked="" type="checkbox"/>	10. Require Water Efficient Landscape Plan.
<input type="checkbox"/>	<input checked="" type="checkbox"/>	11. Biological Resources/Natural Area Map.
<input type="checkbox"/>	<input checked="" type="checkbox"/>	12. Natural Diversity Data Base.
<input type="checkbox"/>	<input checked="" type="checkbox"/>	13. Soil Type(s)/Pygmy Soils.
<input type="checkbox"/>	<input checked="" type="checkbox"/>	14. Airport CLUP Planning Area.
<input type="checkbox"/>	<input checked="" type="checkbox"/>	15. Specific Plan Area.

		COASTAL ZONE
Yes	No	
<input type="checkbox"/>	<input checked="" type="checkbox"/>	16. Exclusion Map.
<input type="checkbox"/>	<input checked="" type="checkbox"/>	17. Appealable Area/Original Jurisdiction Map.
<input checked="" type="checkbox"/>	<input type="checkbox"/>	18. Blayney-Dyett Map. Map #8
<input type="checkbox"/>	<input checked="" type="checkbox"/>	19. Land Capabilities/Natural Hazards Map.
<input checked="" type="checkbox"/>	<input type="checkbox"/>	20. Habitats/ESHA/Resources Map. Woodland
<input checked="" type="checkbox"/>	<input type="checkbox"/>	21. Coastal Groundwater Study Zone. CWR br- groundwater available from usually low yielding bedrock wells
<input checked="" type="checkbox"/>	<input type="checkbox"/>	22. Highly Scenic Area/Special Communities. Designated HSA- conditional
<input type="checkbox"/>	<input checked="" type="checkbox"/>	23. Ocean Front Parcel (Blufftop Geology).
<input type="checkbox"/>	<input checked="" type="checkbox"/>	24. Adjacent to beach/tidelands/submerged land/Public Trust Land.
<input type="checkbox"/>	<input checked="" type="checkbox"/>	25. Noyo Harbor/Albion Harbor.

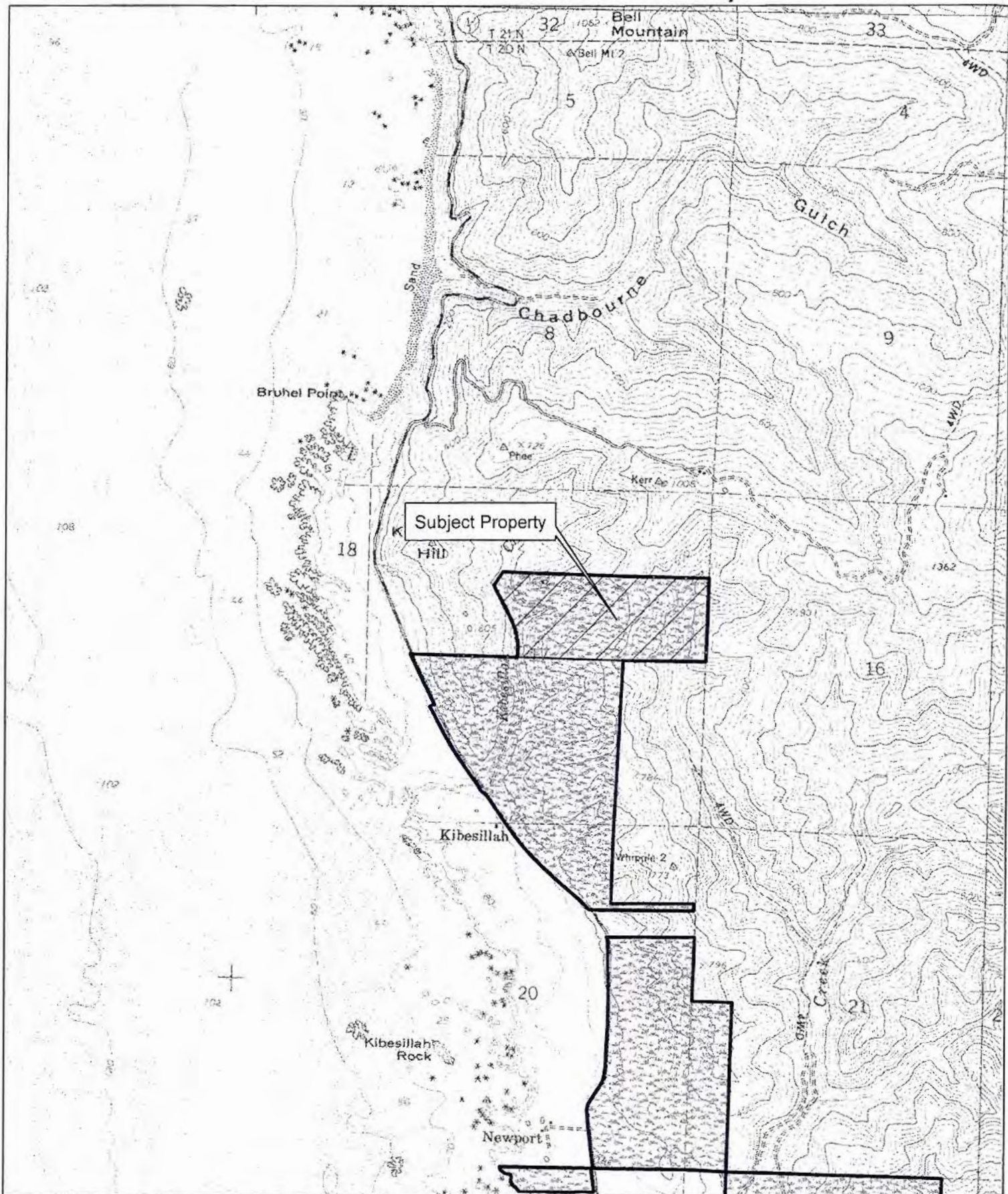

OWNER: JACKSON GRUBE FAMILY INC
 APPLICANT: MCMAHON, Ronelle
 CASE: CDUR 7-1994 / 2011
 APNs: 015-070-40

LANDS WITHIN WILLIAMSON ACT

 Williamson Act - Prime and Non Prime Land

Parcel lines are approximate. Parcel lines on this map are NOT SURVEY LINES, they are for viewing purposes only and should not be used to determine legal boundary lines. Parcel line can be over 200 feet off.



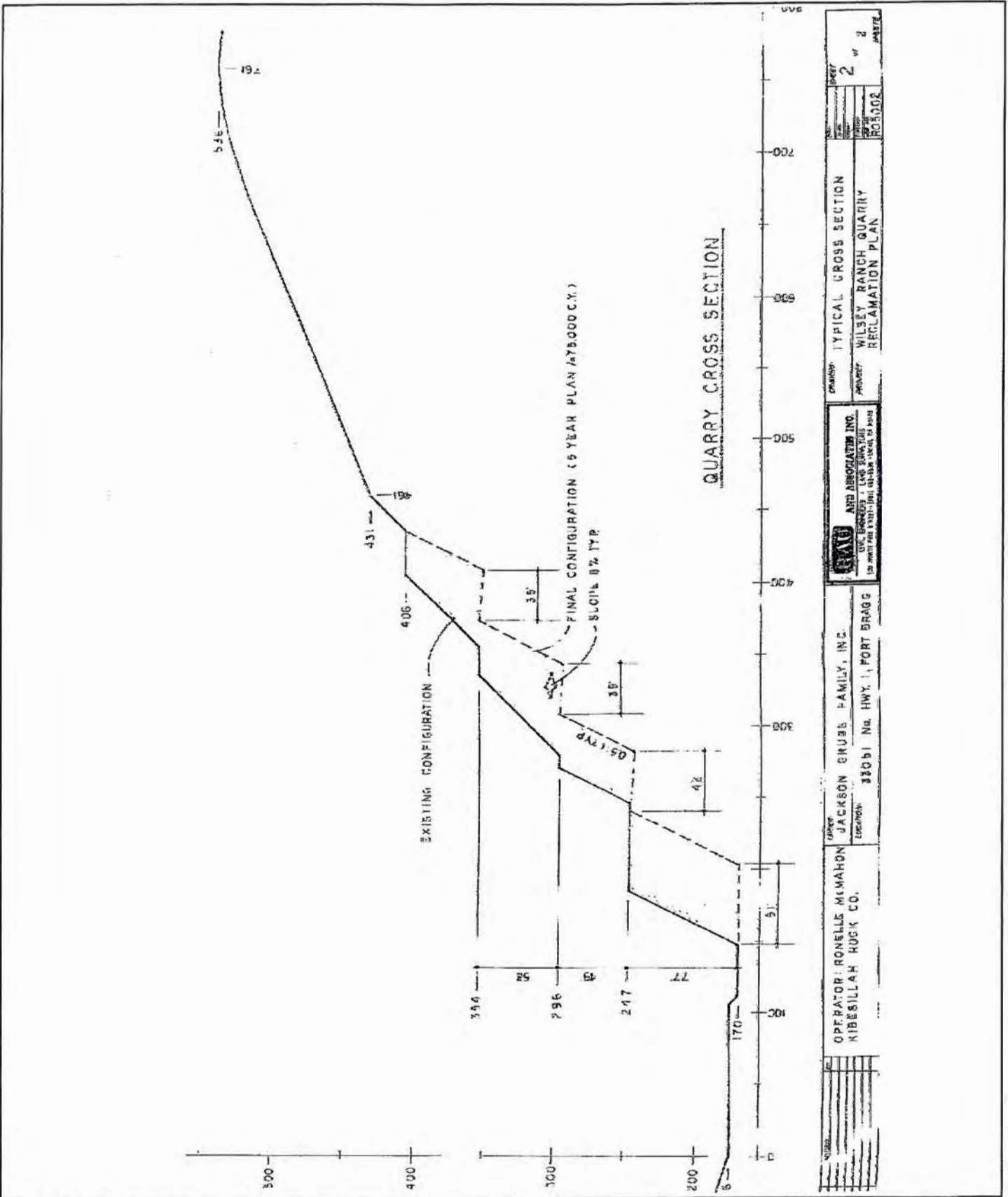

OWNER: JACKSON GRUBE FAMILY INC
 APPLICANT: MCMAHON, Ronelle
 CASE: CDUR 7-1994 / 2011
 APNs: 015-070-40

QUARRY CROSS SECTION

Not To Scale